

# SPANDAN INTERNATIONAL

- ARCHITECT & CONSULTANT
- STRUCTURAL DESIGNER
- TOWN PLANNER
- ESTIMATOR & VALUER

Registered Office :  
PINAKI BHAVAN, GR. FLOOR  
28, MAHARAJA TAGORE ROAD  
KOLKATA-700031

DEVASHISH BOSE PROPRIETOR  
M.TECH (MUNICH), B.C.E. (HONS.),  
CHARTERED ENGINEER, F.I.E. , A.M.I., STRUCT. E.  
L.B.S. (Class- I), E.S.E (Class - I)  
(KOLKATA MUNICIPAL CORPORATION)  
ENLISTED BUILDING ARCHITECT, E.S.E ( I )  
(Rajpur-Sonarpur Municipality)

Mobile : 9433163366  
8961407195  
8697442470

Ref. No. *SP/RS/MISC/2026*

Date *19.01.2026*

## CERTIFICATE

PREMISES NO. - 20/13, N. S. C. BOSE ROAD

ASSESSEE NO. - 21-094-08-0034-1

NAME OF THE OWNERS/APPLICANT(S): RUDRANIL SANYAL C/A OF

DEBJANI ROY, MRS SHELLY MAZUMDER, MRS PARAMITA CHATTERJEE  
(SANYAL), M.S NABAMITA CHATTERJEE, MRS SUNANDA CHATTERJEE  
& M/S BALAJI INC REPRESENTED BY SRI BISWAROOP MAZUMDER, SRI  
RUDRANIL SANYAL

AREA OF LAND : 422.274 SQM.

NAME OF L.B.S. : DEVASHISH BOSE

PERMISSIBLE HEIGHT IN REFERENCE TO CCZM ISSUED BY AAI ( FROM EODB LINK) : 33.0 M.

Reference points marked in the site plan of the proposal	Co-ordinate in WGS 84		Site Elevation
	Latitude	Longitude	
' A '	22° 29' 32.95" N	88° 20' 51.56" E	7.0 m.
' B '	22° 29' 32.38" N	88° 20' 52.04" E	7.0 m.
' C '	22° 29' 32.85" N	88° 20' 52.49" E	7.0 m.
' D '	22° 29' 33.31" N	88° 20' 52.05" E	7.0 m.

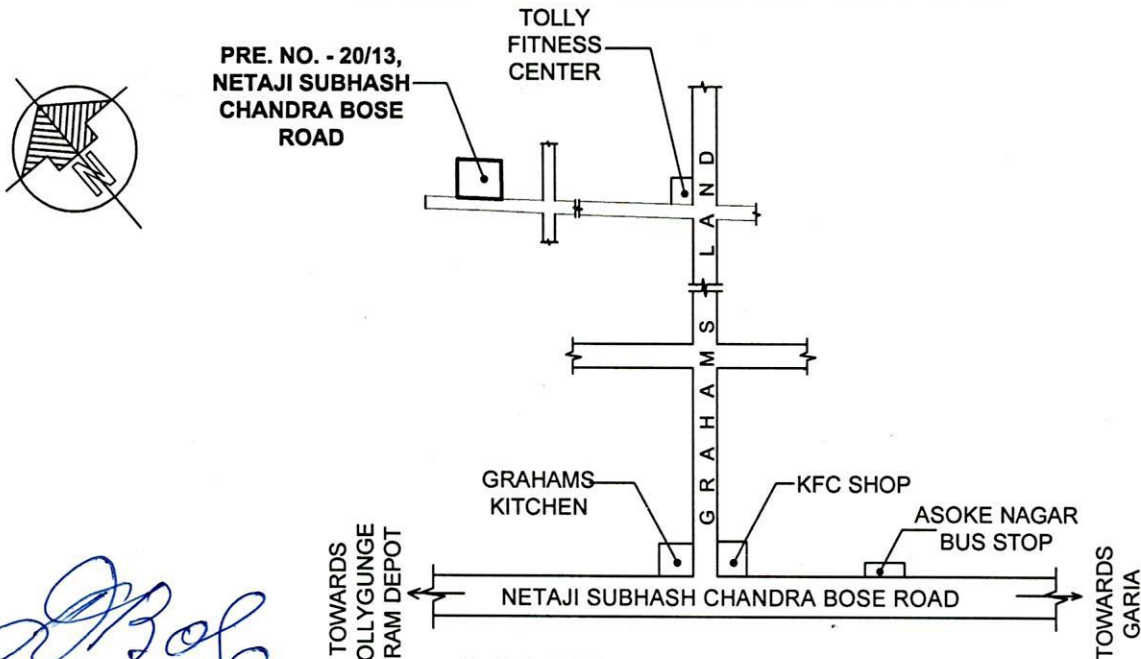

**LOCATION PLAN.** ( SCALE = 1: 4000 )

*Devashish Bose*

DEVASHISH BOSE

M.TECH (MUNICH), B.C.E. (Hons.), F.I.E., A.M.I., Struct (E)

L.B.S. No.-516, Class-I

Consulting Chartered Engineer, F-14063/I

SIGNATURE OF L.B.S.